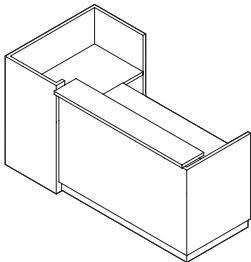
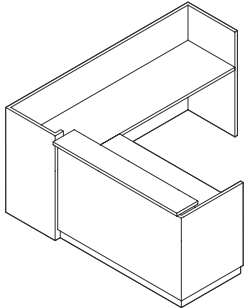
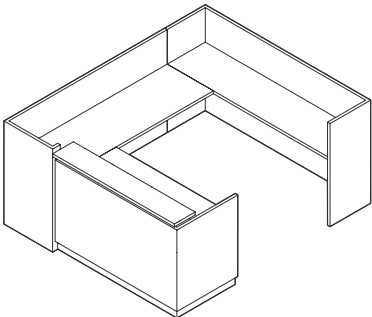

## Ravenna Series

**Ravenna features:** a rectangular main desk with counter in wood, ARD sourced 3/4" White Carrara marble or 3/4" Absolute Black granite or 1/2" low iron clear glass on metal stand-offs, metal laminate toekick, ARD std finish veneer monolith on right or left sides.

|  | Plan Configuration  | Sizes<br>W x D x H | Model No. | Price | Ship Wt |  |
|--|---|--------------------|-----------|-------|---------|--|
| <b>Configuration 0</b><br>  | <b>Desk</b><br><br>Desk only, 35"d x 43"h with grommet.<br><br>See storage options below.   | 72 x 45 x 43       | RTV072    | 15791 | 800     | <b>Designer Lines - include the following in the price:</b><br><br>Hollow chassis with removable access panels on interior front of desk only and (1) powered grommet  |
|  |   | 84 x 45 x 43       | RTV084    | 18667 | 850     |  |
|  |   | 96 x 45 x 43       | RTV096    | 20733 | 900     |  |
|  |   |                    |           |       |         |  |
| <b>Configuration 1</b><br> | <b>Desk with Return</b><br><br>Desk and 48"w x 24"d return, with two grommets.<br><br>See storage options below.<br><br><i>Specify left or right return.</i>  | 72 x 80 x 43       | RTV172    | 18911 | 1000    | <b>Alternate Options</b><br><br>Marble<br>Granite<br>Solidsurface<br>Quartz<br><br>Frosted glass<br>Backpainted glass<br><br>Please call factory<br><br><b>Note:</b><br>Certain marbles may be too fragile for this style. |
|  |   | 84 x 80 x 43       | RTV184    | 21667 | 1100    |  |
|  |   | 96 x 80 x 43       | RTV196    | 23768 | 1200    |  |
|  |   |                    |           |       |         |  |
| <b>Configuration 2</b><br> | <b>Desk with Bridge and Credenza</b><br><br>Desk, 48"w x 24"d bridge and 20"d rear credenza shell, with three grommets.<br><br>See storage options below.<br><br><i>Specify left or right return.</i> | 72 x 100 x 43      | RTV272    | 23996 | 1500    |  |
|  |   | 84 x 100 x 43      | RTV284    | 26867 | 1650    |  |
|  |   | 96 x 100 x 43      | RTV296    | 28533 | 1700    |  |
|  |   |                    |           |       |         |  |

### Storage options to be placed under worksurface

**RPED 21**  
Box, box, file pedestal with lock, 16" wide.

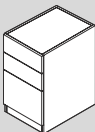

Add \$1525 List.

**RPED 02**  
File, file pedestal with lock, 16" wide.

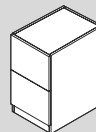

Add \$1375 List.

**RMP 21**  
Mobile BBF pedestal, with lock, 16" wide.

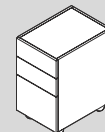

Add \$1795 List.